

# DC BLOCK 7/16 - DIN

## 800 MHz - 2.8 GHz Inner Only

api   
technologies corp.  
> INMET

MODELS: 8550

### SPECIFICATIONS:

#### Electrical:

Frequency Range \_\_\_\_\_ 800 MHz – 2.8 GHz  
VSWR \_\_\_\_\_ 1.20:1 Max.  
Impedance \_\_\_\_\_ 50 Ohms  
Insertion Loss \_\_\_\_\_ 0.2 dB Max.  
Voltage Rating \_\_\_\_\_ 3000 Volts Max.  
RF Power, CW \_\_\_\_\_ 500 Watts  
RF Power, Peak \_\_\_\_\_ 1000 Watts  
Isolation \_\_\_\_\_ 64dB Typical @ 1 KHz  
Operating Temp. Range \_\_\_\_\_ -65°C to +125°C

#### Mechanical:

7/16 – DIN Connectors \_\_\_\_\_ Silver Plated Brass  
IAW DIN 47 223  
Conductors \_\_\_\_\_ Silver Plated Beryllium Copper

Model Number: **8550**

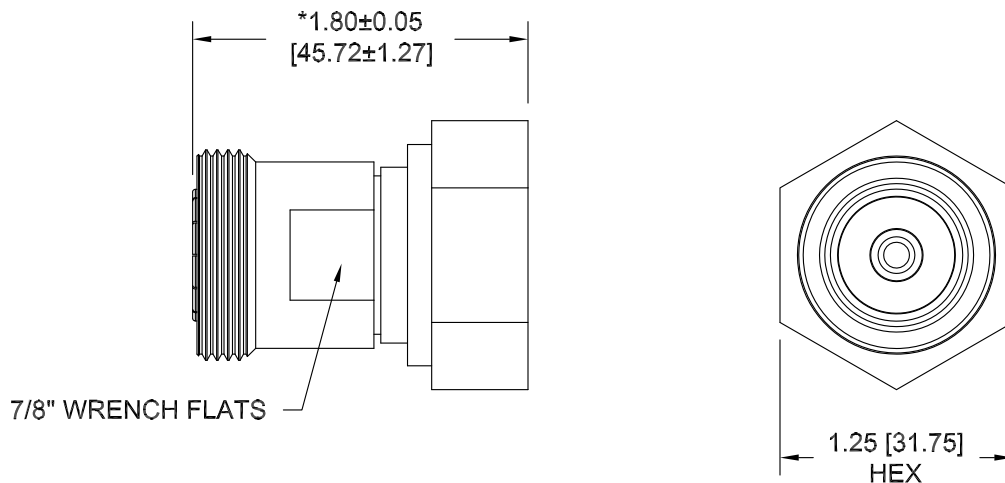

\*Dimension Occurs with Nut Biased Forward

Note: Dimensions in Brackets are Expressed in Millimeters and are for Reference Only.  
Design specifications are subject to change without notice.  
Contact factory for technical specifications before purchasing or use.