

# Chokes

# Drum Core Inductor

# CBP1255

The CBP1255 series Inductors are wound on "Drum" style ferrite cores and are ideal for use as Input/Output filter Inductors in Switch Mode Power Supplies.

- High DC levels.
  - Compact size.
  - Low loss Ferrite material.
  - Cost effective.
  - Available with heat shrink vinyl cover.
- Other applications include:  
Line Filters, Speaker  
Crossover Networks, SCR  
and Triac Controls etc.



## MECHANICAL

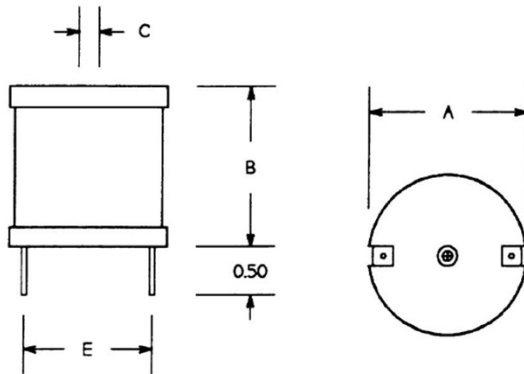

Dimensions, Inches

A	B	C	E
1.60	1.45	Hole to clear No. 8/32 screw	See Electrical Specs. table.

## ELECTRICAL SPECIFICATION

Part No.	Ind. (1) ± 10% (µH)	Max DCR (Ω)	I DC (2) (Amp) DC	I Rated (3) (Amp) RMS	E (Nom.)
CBP1255-33G	3.3	0.002	125.0	35.0	1.11
CBP1255-39G	3.9	0.003	102.0	35.0	1.11
CBP1255-47G	4.7	0.003	87.0	35.0	1.11
CBP1255-56G	5.6	0.003	87.0	35.0	1.11
CBP1255-68G	6.8	0.003	87.0	35.0	1.11
CBP1255-82G	8.2	0.003	76.0	35.0	1.11
CBP1255-100	10.0	0.004	67.0	35.0	1.11
CBP1255-120	12.0	0.004	60.0	35.0	1.16
CBP1255-150	15.0	0.005	49.0	35.0	1.16
CBP1255-180	18.0	0.007	45.0	27.0	1.16
CBP1255-220	22.0	0.007	42.0	27.0	1.16
CBP1255-270	27.0	0.008	35.0	27.0	1.16
CBP1255-330	33.0	0.009	34.0	27.0	1.16
CBP1255-390	39.0	0.010	30.0	27.0	1.16
CBP1255-470	47.0	0.011	28.0	27.0	1.16
CBP1255-560	56.0	0.013	26.0	21.0	1.16
CBP1255-680	68.0	0.015	23.0	21.0	1.25
CBP1255-820	82.0	0.017	20.0	21.0	1.28
CBP1255-101	100.0	0.018	19.0	21.0	1.25
CBP1255-121	120.0	0.022	18.0	17.0	1.16
CBP1255-151	150.0	0.025	16.0	17.0	1.16
CBP1255-181	180.0	0.035	14.0	13.5	1.10
CBP1255-221	220.0	0.040	13.0	13.5	1.10
CBP1255-271	270.0	0.044	11.0	13.5	1.10
CBP1255-331	330.0	0.049	10.0	13.5	1.11
CBP1255-391	390.0	0.070	9.7	11.4	1.15
CBP1255-471	470.0	0.078	8.8	11.4	1.07
CBP1255-561	560.0	0.105	8.1	9.0	1.07
CBP1255-681	680.0	0.115	7.4	9.0	1.07
CBP1255-821	820.0	0.127	6.7	9.0	1.12
CBP1255-102	1000.0	0.176	6.1	7.2	1.12
CBP1255-122	1200.0	0.195	5.5	7.2	1.12
CBP1255-152	1500.0	0.274	5.0	5.5	1.12
CBP1255-182	1800.0	0.302	4.5	5.5	1.13
CBP1255-222	2200.0	0.338	4.1	5.5	1.16
CBP1255-272	2700.0	0.459	3.7	4.5	1.02
CBP1255-332	3300.0	0.642	3.4	4.0	1.02
CBP1255-392	3900.0	0.699	3.0	4.0	1.14
CBP1255-472	4700.0	0.775	2.8	4.0	1.14
CBP1255-562	5600.0	0.843	2.6	4.0	1.14

### NOTES

- 1) Tolerances on values below 10 µH are ± 20%.
- 2) I DC is the current for which the Inductance is reduced by appr. %5 of its initial value.
- 3) I RATED is the current (RMS), limited by the copper loss and the gauge of the wire in the winding.