

ADAPTER, BETWEEN SERIES 1.85mm / SMPM

DC - 65 GHz



MODELS: 5296, 5297, 5298, 5299

SPECIFICATIONS:

Electrical:

Frequency Range _____ DC – 65 GHz
 VSWR
 DC – 26.5 GHz _____ 1.20:1 Max.
 26.5 – 65 GHz _____ 1.40:1 Max.
 Impedance _____ 50 Ohms
 Operating Temp. Range _____ -20°C to +85°C

Mechanical:

1.85mm Connectors _____ Passivated Stainless Steel
 (Mates with 2.4mm & V* Connectors)
 SMPM Connectors _____ Gold Plated Beryllium Copper
 (Mates with GPPO** Connectors)
 Conductors _____ Gold Plated Beryllium Copper

*V is a trademark of Anritsu Corp.
 **GPPO is a trademark of Corning Gilbert, Inc.

Model Number: **5296**
 1.85mm MALE / SMPM MALE

Model Number: **5297**
 1.85mm MALE / SMPM FEMALE

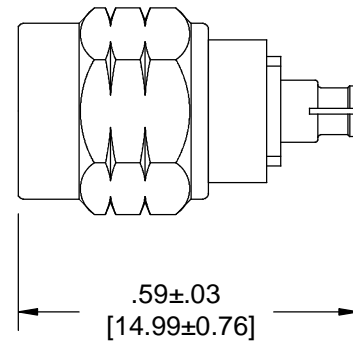
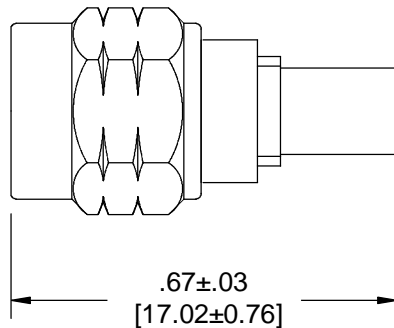

Model Number: **5298**
 1.85mm FEMALE / SMPM MALE

Model Number: **5299**
 1.85mm FEMALE / SMPM FEMALE

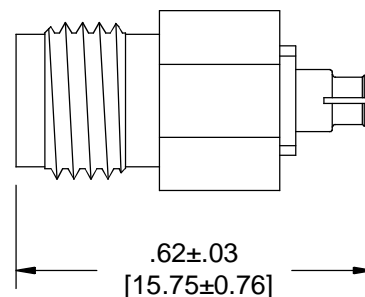
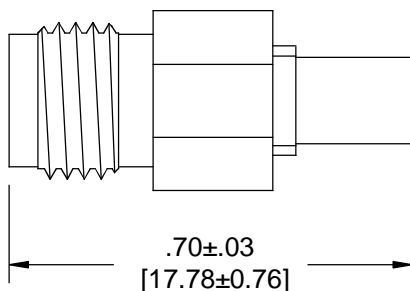

Note: Dimensions in Brackets are Expressed in Millimeters and are for Reference Only.
 Design specifications are subject to change without notice.
 Contact factory for technical specifications before purchasing or use.

5296; REV A

PROPRIETARY NOTICE

THE INFORMATION CONTAINED IN THIS DRAWING IS PROPRIETARY AND SHALL NOT BE USED OR DISCLOSED WITHOUT THE PRIOR WRITTEN PERMISSION OF API INMET, INC.

REVISIONS

LTR	DESCRIPTION	DATE	DCN NO.
A	NEW DRAWING	2/9/11	10-00174

Typical VSWR (Gated)

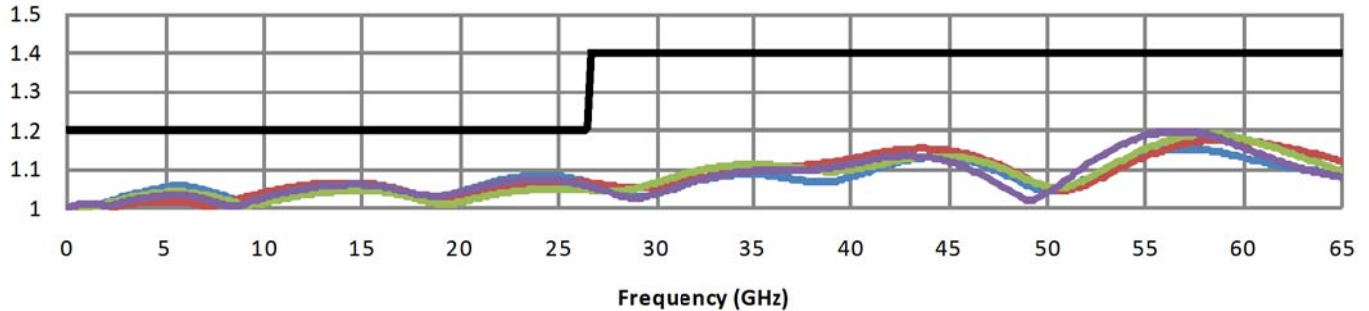

Typical VSWR (Adapters tested in pairs)

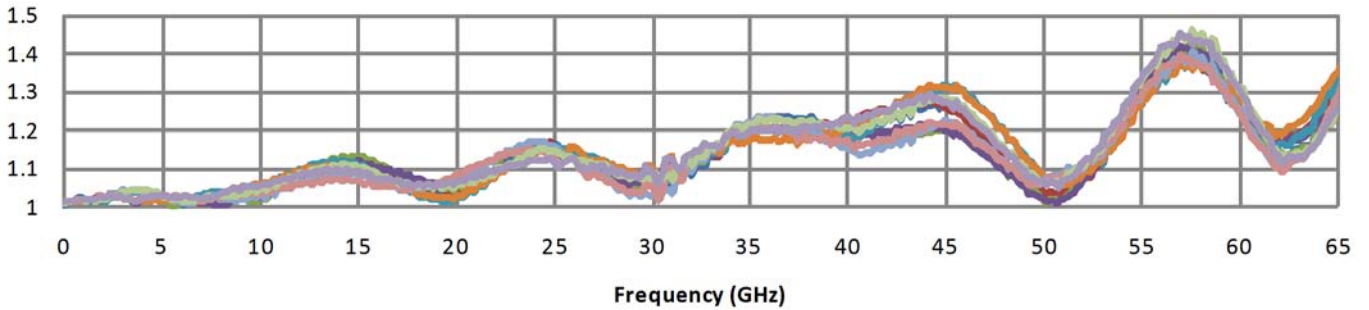

Typical Insertion Loss (dB) (Adapters tested in pairs)

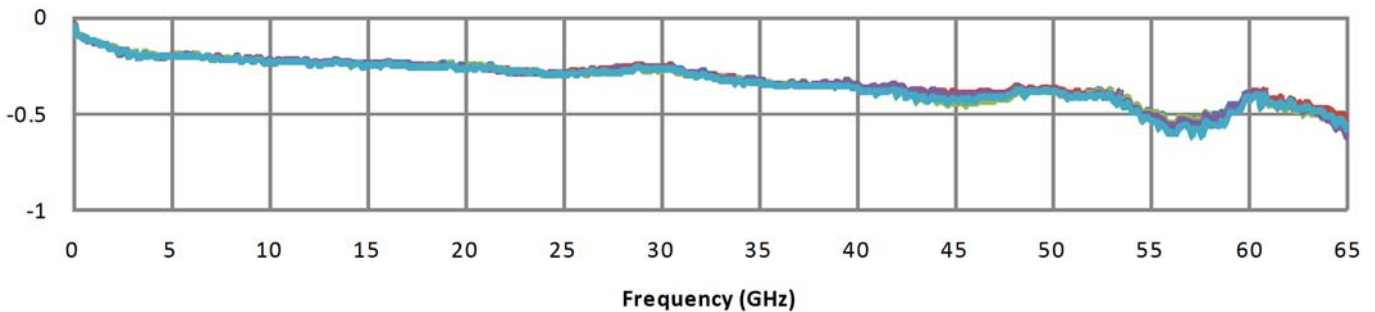

UNLESS OTHERWISE SPECIFIED DIMENSIONS ARE IN INCHES TOLERANCES

DECIMAL	ANGULAR
.XX ± .01	±
.XXX ± .005	
DO NOT SCALE DRAWING	

MATERIAL:

FINISH

SIMILAR TO

WEIGHT (gr)

CONTRACT NO.

CHECKED

EJM

ENGINEERING

JRW

MANUFACTURING

JO

QUAL. ASSURANCE

JMB

MARKETING

NH

DATE

2/11/11

2/11/11

2/15/11

3/2/11

3/3/11



300 DINO DRIVE
ANN ARBOR, MI 48103
TELEPHONE (734) 426-5553
FACSIMILE (734) 426-5557

TITLE:

OUTLINE DRAWING, ADAPTER
BETWEEN SERIES, 1.85mm TO SMPM
DC - 65 GHz, 50 OHMS
MODELS 5296, 5297, 5298, 5299

SIZE

A

FSCM NO.

64671

DWG. NO.

5296

SCALE

3:1

RELEASE DATE

SHEET

2

OF 2