

ADAPTER 2.9mm

DC - 40 GHz FLANGE MOUNT



MODELS: 5344

SPECIFICATIONS:

Electrical:

Frequency Range _____ DC – 40 GHz
VSWR
DC – 18 GHz _____ 1.15:1 Max.
18 – 26.5 GHz _____ 1.25:1 Max.
26.5 – 40 GHz _____ 1.35:1 Max.
Impedance _____ 50 Ohms
Operating Temp Range _____ -65°C to +125°C

Mechanical:

2.9mm Connectors _____ Passivated Stainless Steel
(Mates both Mechanically & Electrically with
all SMA, K* & 3.5mm Series Connectors)
Conductors _____ Gold Plated Beryllium Copper

* K is a Trademark of Wiltron Corp.

Model Number: **5344**
2.9mm Female/Female Connector

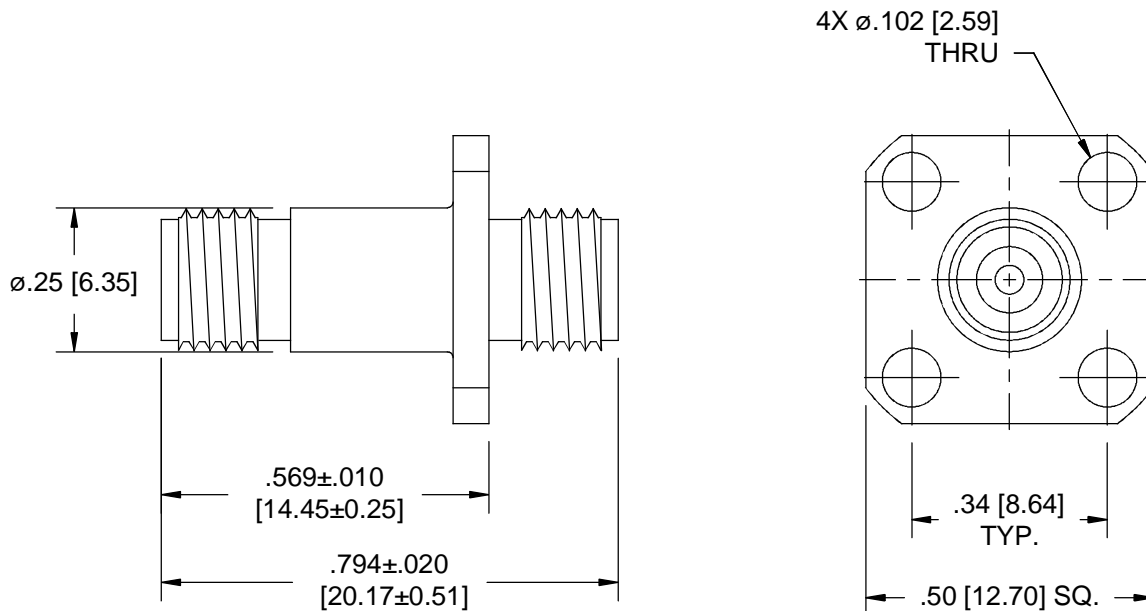

Note: Dimensions in Brackets are Expressed in Millimeters and are for Reference Only.
Design specifications are subject to change without notice.
Contact factory for technical specifications before purchasing or use.

5344; REV -

300 Dino Drive • Ann Arbor, MI 48103-9457 U.S.A. • 888-244-6638 or 734-426-5553 • FAX 734-426-5557 • inmet.apitech.com