

DC BLOCKS, BETWEEN SERIES
TYPE N / SMA

10 MHz - 18 GHz
INNER ONLY



MODELS: 8301, 8302, 8303, 8304

SPECIFICATIONS:

Electrical:

Frequency Range _____ 10 MHz – 18 GHz
 VSWR _____ 1.35:1 Max.
 Impedance _____ 50 Ohms
 Insertion Loss _____ 0.5 dB Max.
 Voltage Rating _____ 200 Volts
 Operating Temp. Range _____ -65°C to +125°C

Mechanical:

Connectors _____ Passivated Stainless Steel
Mates with MIL-STD-348
 Conductors _____ Gold Plated Beryllium Copper

Model Number: **8301**
 Type N Male / SMA Male

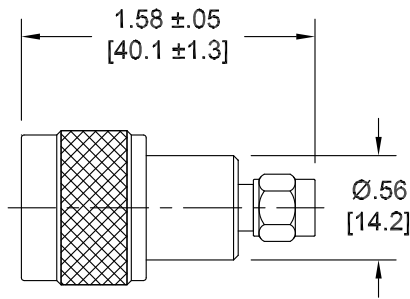

Model Number: **8302**
 Type N Male / SMA Female

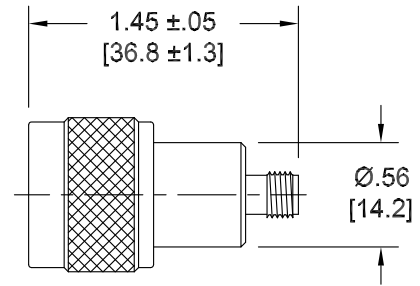

Model Number: **8303**
 Type N Female / SMA Male

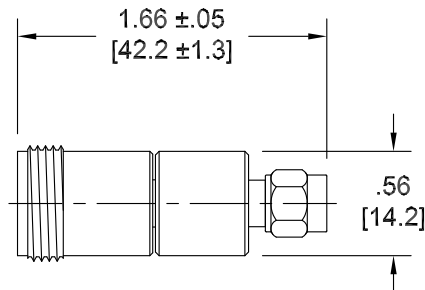

Model Number: **8304**
 Type N Female / SMA Female

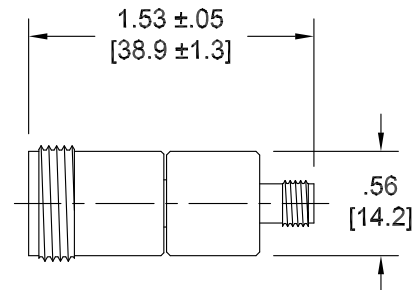

Note: Dimensions in Brackets are Expressed in Millimeters and are for Reference Only.
 Design specifications are subject to change without notice.
 Contact factory for technical specifications before purchasing or use.