

DC BLOCK SMPM

16 kHz - 50 GHz



MODELS: 8535MP

SPECIFICATIONS:

Electrical:

Frequency Range _____ 16 kHz – 50 GHz
 VSWR
 10 MHz – 40 GHz _____ 1.50:1 Max.
 40 GHz – 50 GHz _____ 2.00:1 Max.
 Insertion Loss
 10 MHz – 40 GHz _____ 1.50 dB Max.
 40 GHz – 50 GHz _____ 2.00 dB Max.
 Impedance _____ 50 Ohms
 Voltage Rating _____ 10 Volts Max.
 Operating Temp. Range _____ -65°C to +125°C

Typical Low Frequency Performance

| Frequency Range | Insertion Loss | VSWR |
|-----------------|----------------|--------|
| 1 kHz | 24dB | – |
| 16 kHz | 3dB | 6:1 |
| 50 kHz | 0.5dB | 2:1 |
| 110 kHz | 0.1dB | 1.35:1 |

Mechanical:

SMPM Connectors _____ Gold Plated Beryllium Copper
 Mates with MIL-STD-348 & GPPO* Connectors
 Conductors _____ Gold Plated Beryllium Copper
 Housing _____ Gold Plated Beryllium Copper

*GPPO is a trademark of Gilbert Engineering Co., Inc.

Model Number: 8535MP

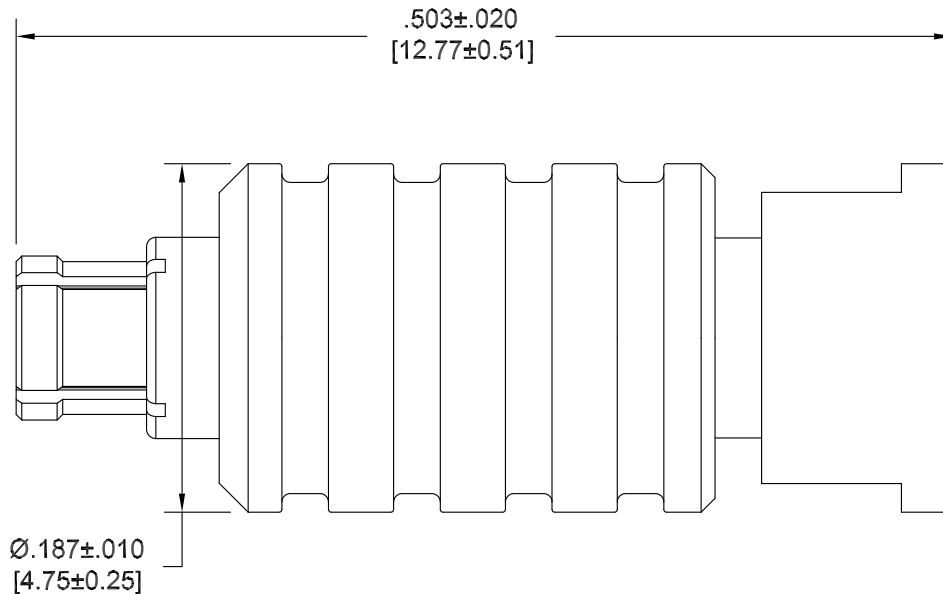

Note: Dimensions in Brackets are Expressed in Millimeters and are for Reference Only.
 Design specifications are subject to change without notice.
 Contact factory for technical specifications before purchasing or use.